

LOCATION PLAN

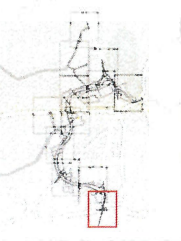

NOTES FOR INFORMATION

1. The new highway for which land delineated on this sheet is required, is referred to in the associated Planning Application Reference Number 22/P/1768.

338500

338400

338300

338200

338100

338000

159500

159400

159300

159200

LEGEND

- ORDER LAND
- LAND TO BE ACQUIRED
- NEW RIGHTS TO BE ACQUIRED
- ORDER PLOT (EXCLUDED FROM GVD)

SCALE: 1:2,500 @ A4

PROJECT TITLE: MAP REFERRED TO IN THE NORTH SOMERSET COUNCIL (BANWELL BYPASS AND SOUTHERN LINK) GENERAL VESTING DECLARATION (G.V.D.)

DRAWING TITLE: SHEET 1 OF 12

DRAWING NUMBER: GYD_BANWELL_0001_REV E

The COMMON SEAL of North Somerset Council was hereunto affixed in the presence of: -

A Nichol, Authorised Signatory, On this day 30 of April 2024

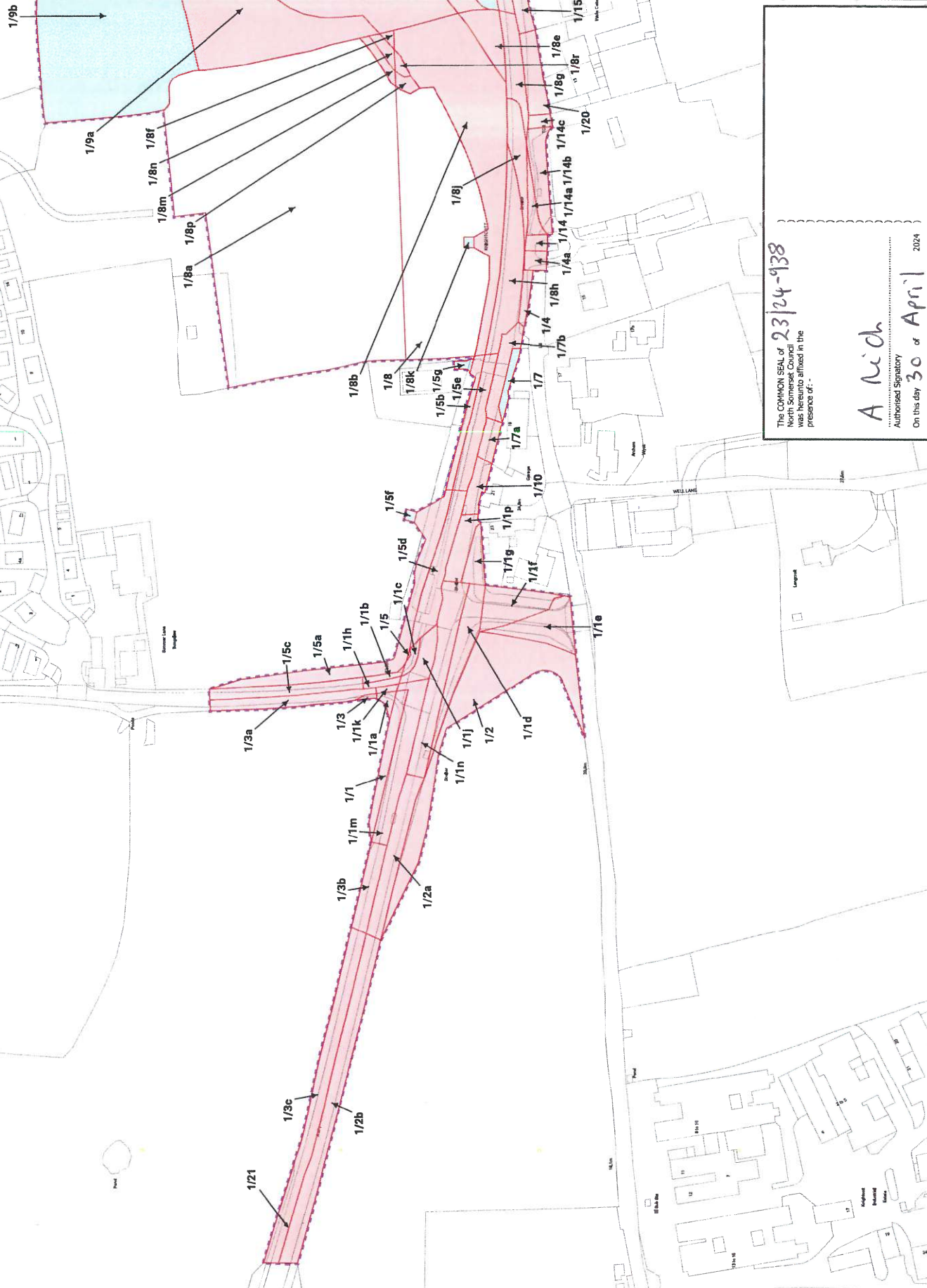

LOCATION PLAN

NOTES FOR INFORMATION

1. The new highway, for which land delineated on this sheet is required, is referred to in the associated Planning Application Reference Number 22/P/1768.

2. The construction and improvement of highways in pursuance of the associated Side Roads Order on land delineated on this sheet, see Site Plan of the North Somerset Council (Banwell Bypass and Southern Link Classified Road) Order 2022.

© Crown copyright and database rights 2024
Ordnance Survey. License Number 10002337

LEGEND

- ORDER LAND
- LAND TO BE ACQUIRED
- NEW RIGHTS TO BE ACQUIRED
- ORDER PLOT (EXCLUDED FROM GVD)

SCALE: 1:2,500 @ A4

0 12.5 25 50 Metres

PROJECT TITLE
MAP REFERRED TO IN THE NORTH SOMERSET COUNCIL (BANWELL BYPASS AND SOUTHERN LINK) GENERAL VESTING DECLARATION (RCL 1)

DRAWING NUMBER
GVD_BANWELL_0002_RevD

DRAWING TITLE
SHEET 2 OF 12

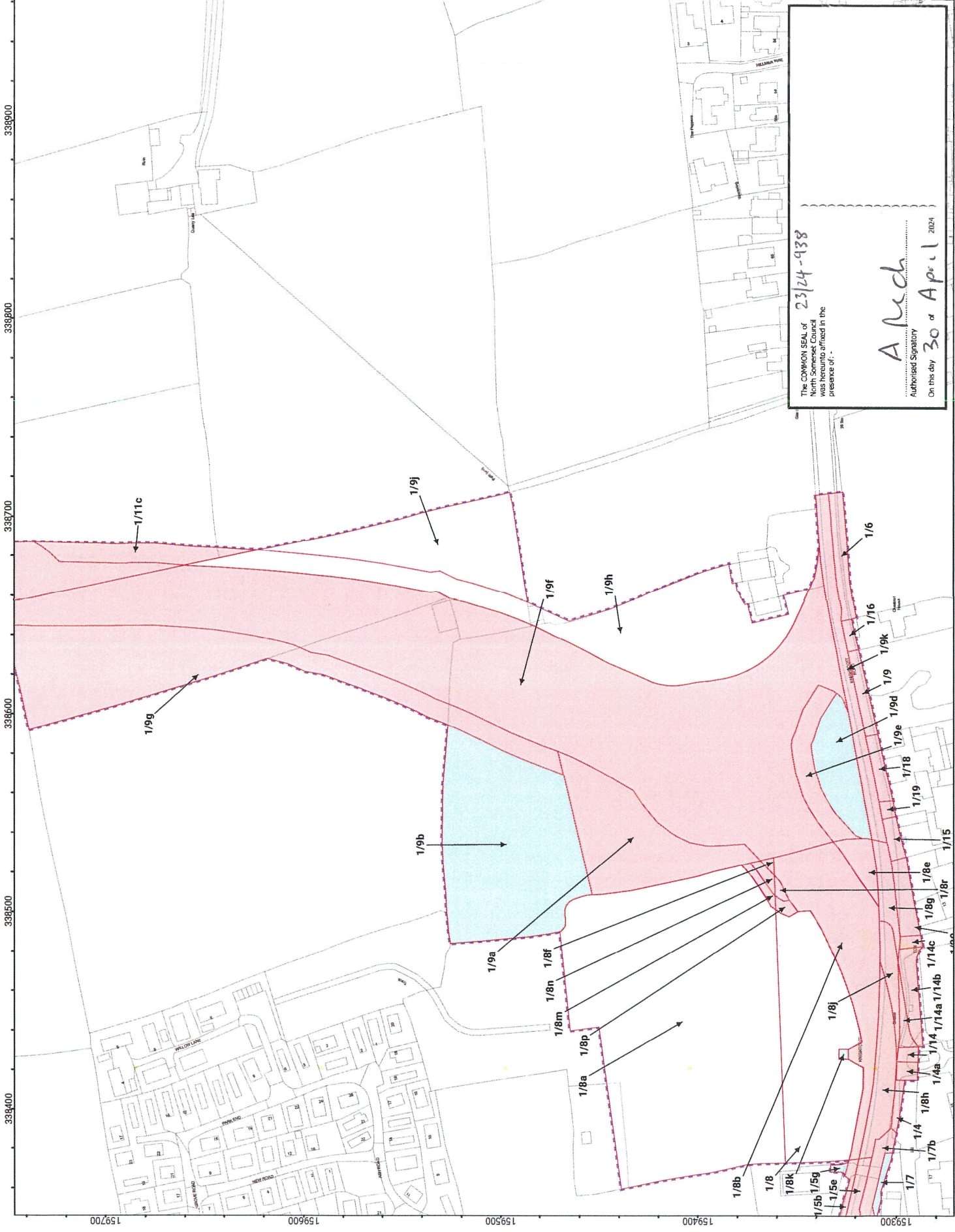

The COMMON SEAL of North Somerset Council was hereunto affixed in the presence of:

A. Reda
Authorised Signatory
On this day 30 of April 2024

23/24-938

LOCATION PLAN



NOTES FOR INFORMATION

1. The new highway, for which land delineated on this sheet is required, is referred to in the associated Planning Application Reference Number Z2/P/7/26.
2. The construction and improvement of highways in pursuance of the associated Side Roads Order on land delineated on this sheet, see Site Plan 1 of the North Somerset Council (Banwell) Order 2024, and the associated Side Roads Order (Banwell) Order 2024 (S&S Road) Order 2022.

© Crown copyright and database right 2024
Ordnance Survey. License Number: 100022597

LEGEND

- ORDER LAND
- LAND TO BE ACQUIRED
- NEW RIGHTS TO BE ACQUIRED
- ORDER PLOT (EXCLUDED FROM GVD)

SCALE: 1:2,500 @ A4



PROJECT TITLE

MAP REFERRED TO IN THE NORTH SOMERSET COUNCIL (BANWELL BYPASS AND SOUTHERN LINK) GENERAL VESTING DECLARATION (NO. 1)

DRAWING TITLE

SHEET 3 OF 12

DRAWING NUMBER

GVD_BANWELL_0003_RevD

3385000 3386000 3387000 3388000 3389000 3390000

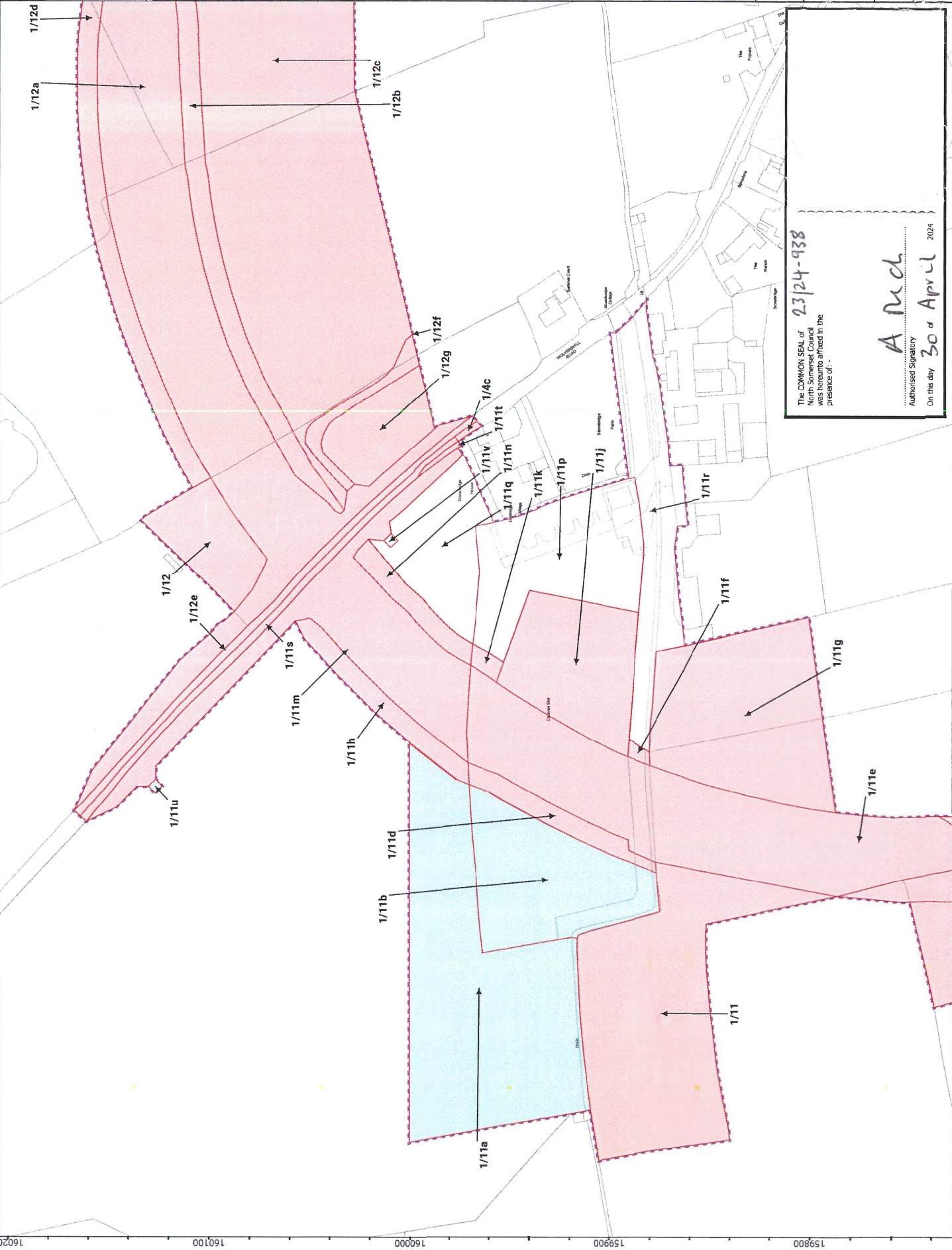

23/24-938

The COMMON SEAL of North Somerset Council was hereunto affixed in the presence of: -

A. Red
Authorised Signatory
On this day 30 of April 2024

LOCATION PLAN

NOTES FOR INFORMATION

1. The new highway for which land delineated on this sheet is required is referred to in the associated Planning Application Reference Number 23/P/2788.

2. The construction and improvement of highways in pursuance of the associated Side Roads Order on land delineated on this sheet, see Site Plan 1 of the North Somerset Council (Banwell Classified Road) (Side Roads) Order 2022.

© Crown copyright and database right 2024
 Ordnance Survey Licence Number 10002397

LEGEND

- ORDER LAND
- LAND TO BE ACQUIRED
- NEW RIGHTS TO BE ACQUIRED
- ORDER PLOT (EXCLUDED FROM GVD)

SCALE: 1:2,500 @ A4

0 12.5 25 50 Metres

PROJECT TITLE

MAP REFERRED TO IN THE NORTH SOMERSET COUNCIL (BANWELL BYPASS AND SOUTHERN LINK) GENERAL VESTING DECLARATION (NO. 1)

DRAWING TITLE

SHEET 4 OF 12

DRAWING NUMBER

GVD_BANWELL_0004_RevD

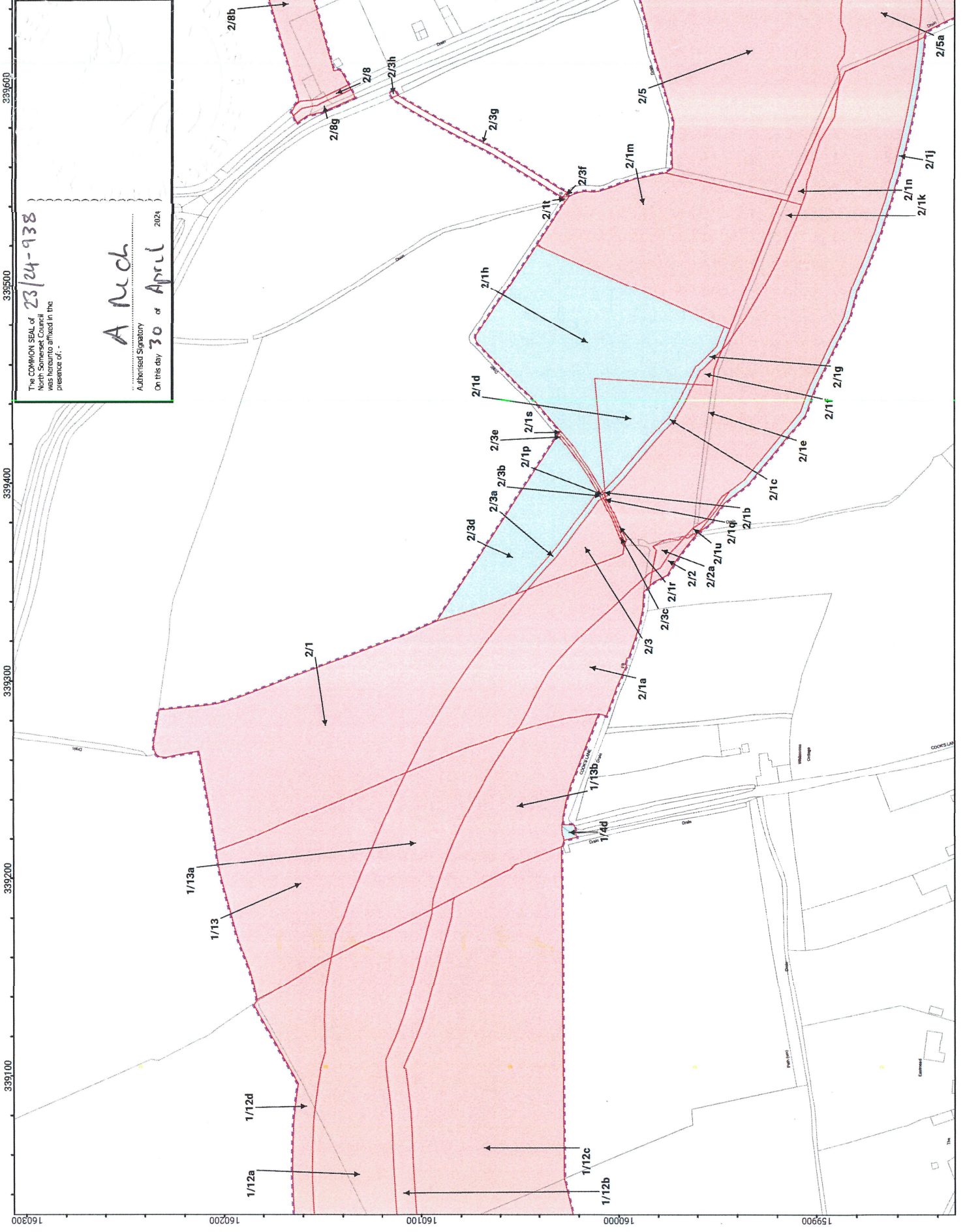

The COMMON SEAL of
 North Somerset Council
 was hereunto affixed in the
 presence of:-

A Nich
 Authorised Signatory

On this day 30 of April 2024

LOCATION PLAN

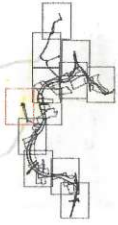

NOTES FOR INFORMATION

1. The new highway, for which land delineated on this sheet is required, is referred to in the associated Planning Application Reference Number 22/P/1780.
2. For construction and improvement of highways in pursuance of the associated Side Roads Order on land delineated on this sheet, see Site Plan 1 of the North Somerset Council (Banwell Bypass and Southern Link) General Vesting Declaration (Classified Road) (Side Roads) Order 2022.

© Crown copyright and database right 2024
Detail Survey Licence Number: 130022917

LEGEND

- ORDER LAND
- LAND TO BE ACQUIRED
- NEW RIGHTS TO BE ACQUIRED
- ORDER PLOT (EXCLUDED FROM GVD)

SCALE: 1:2,500 @ A4



PROJECT TITLE

MAP REFERRED TO IN THE NORTH SOMERSET COUNCIL (BANWELL BYPASS AND SOUTHERN LINK) GENERAL VESTING DECLARATION (No. 1)

SPAWING TITLE

SHEET 5 OF 12

FORMAL NUMBER

GVD_BANWELL_0005_RevD

340100

340000

339900

339800

339700

339600

160500

160400

160300

160200

160100

23/24-438

The COMMON SEAL of North Somerset Council was hereunto affixed in the presence of: -

A. Nich
Authorised Signatory

On the day 30 of April 2024

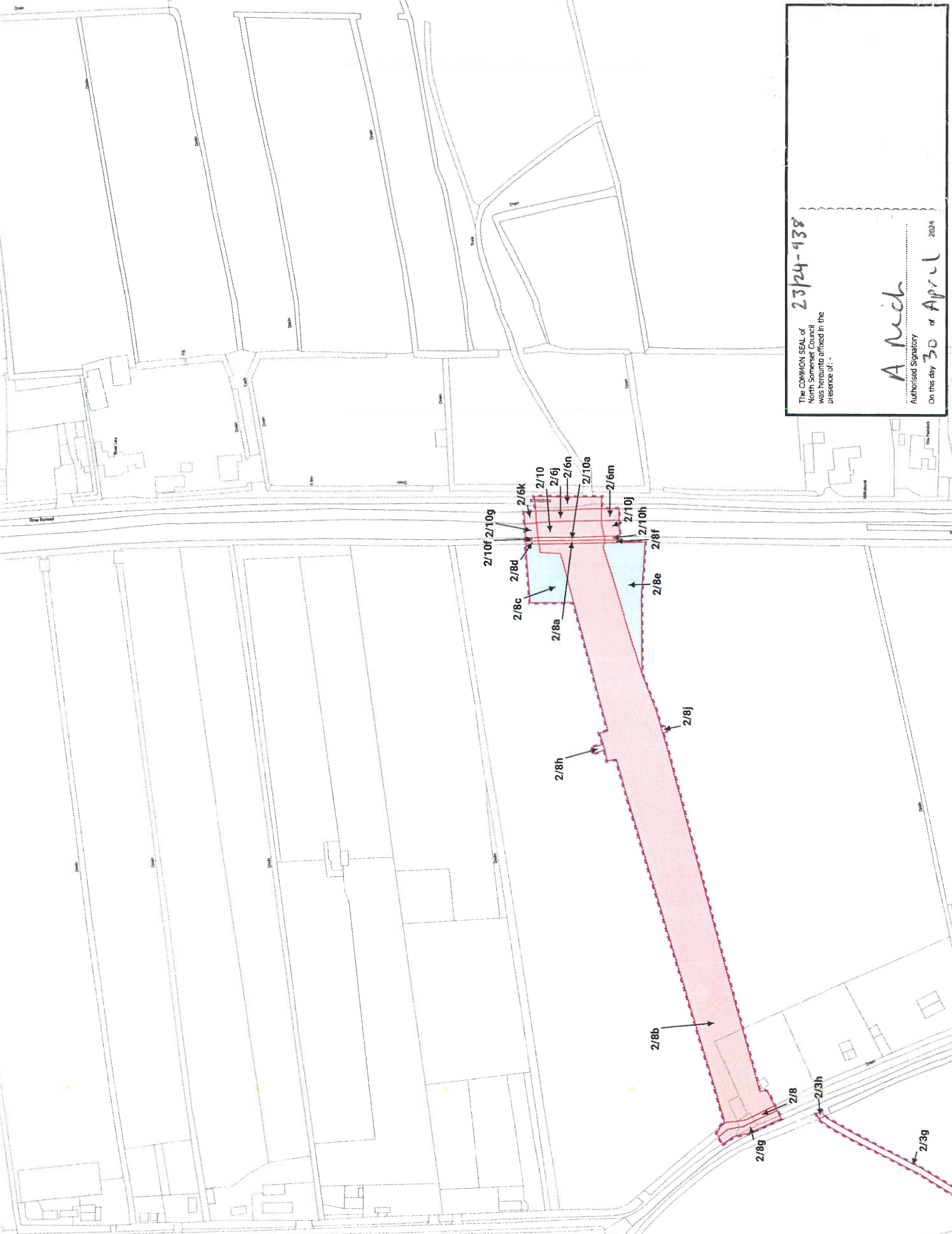

LOCATION PLAN



NOTES FOR INFORMATION

1. The new highway for which land delineated on this sheet is required, is referred to in the associated Planning Application Reference Number 22/P/1768

© Crown copyright and database rights 2024
Ordnance Survey License Number: 100025397

LEGEND

- ORDER LAND
- LAND TO BE ACQUIRED
- NEW RIGHTS TO BE ACQUIRED
- ORDER PLOT (EXCLUDED FROM GVD)

SCALE: 1:2,500 @ A4



PROJECT TITLE
MAP REFERRED TO IN THE NORTH SOMERSET COUNCIL (BANWELL BYPASS AND SOUTHERN LINK) GENERAL VESTING DECLARATION (NO. 1)

DRAWING TITLE
SHEET 6 OF 12

DRAWING NUMBER
GVD_BANWELL_0006_RevD

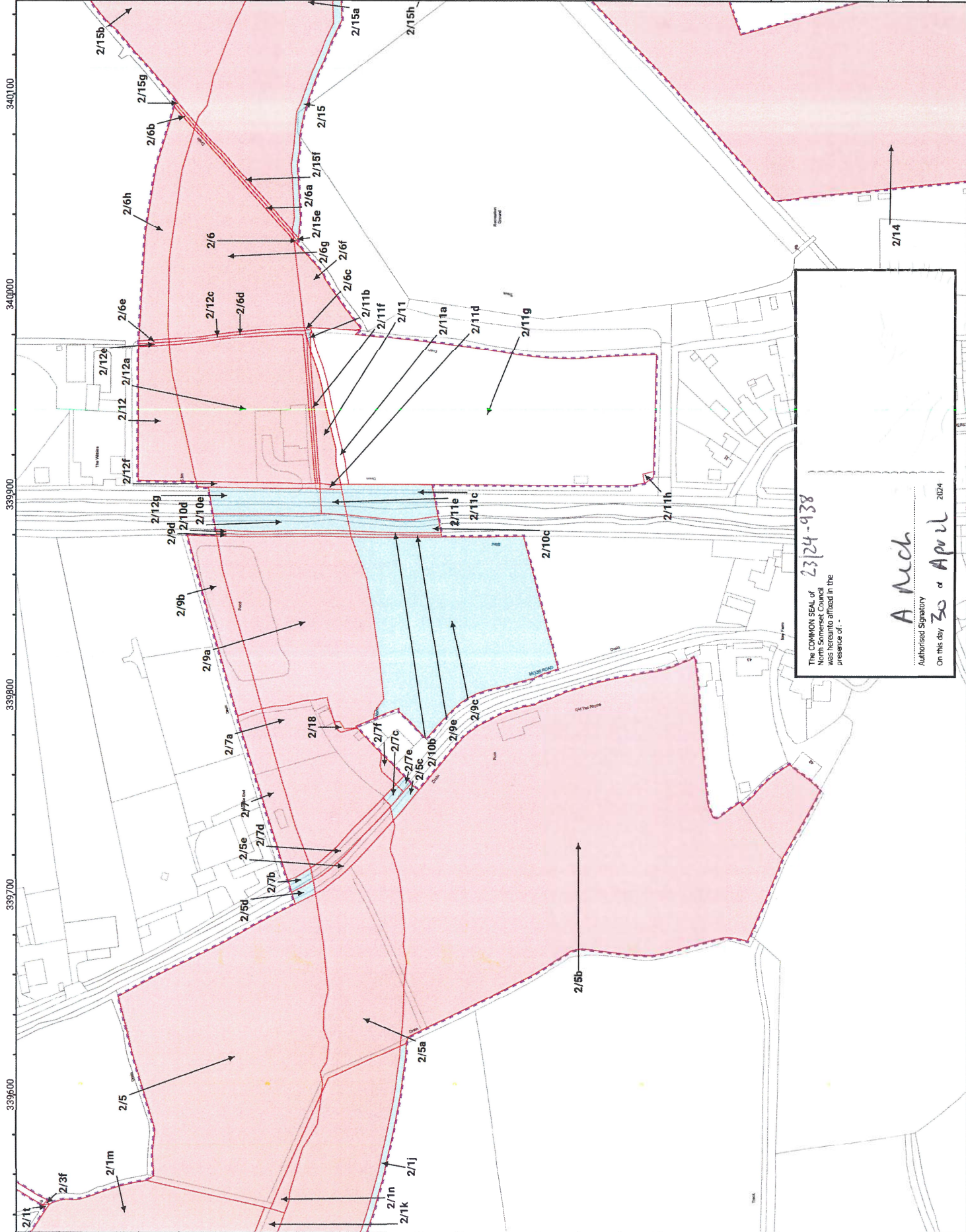

The COMMON SEAL of
North Somerset Council
was hereunto affixed in the
presence of: -

A Nich
Authorised Signatory
On this day 30 of April 2024

23/24-938

LOCATION PLAN

NOTES FOR INFORMATION

- The new highway, for which land delineated on this sheet is required, is referred to in the associated Planning Application Reference Number 23/P/237.
- For construction and improvement of highways in pursuance of the associated Side Roads Order on land delineated on this sheet, see Site Plan 1 of the North Somerset Council (Banwell Classified Road) (Side Roads) Order 2022.

© Crown Copyright and Database rights 2024
Ordnance Survey Licence Number 10002397

LEGEND

- ORDER LAND
- LAND TO BE ACQUIRED
- NEW RIGHTS TO BE ACQUIRED
- ORDER PLOT (EXCLUDED FROM GVD)

SCALE: 1:2,500 @ A4

PROJECT TITLE
MAP REFERRED TO IN THE NORTH SOMERSET COUNCIL (BANWELL BYPASS AND SOUTHERN LINK) GENERAL VESTING DECLARATION (NO. 1)

DRAWING TITLE
SHEET 7 OF 12

DRAWING NUMBER
GVD-BANWELL_0007_RevD

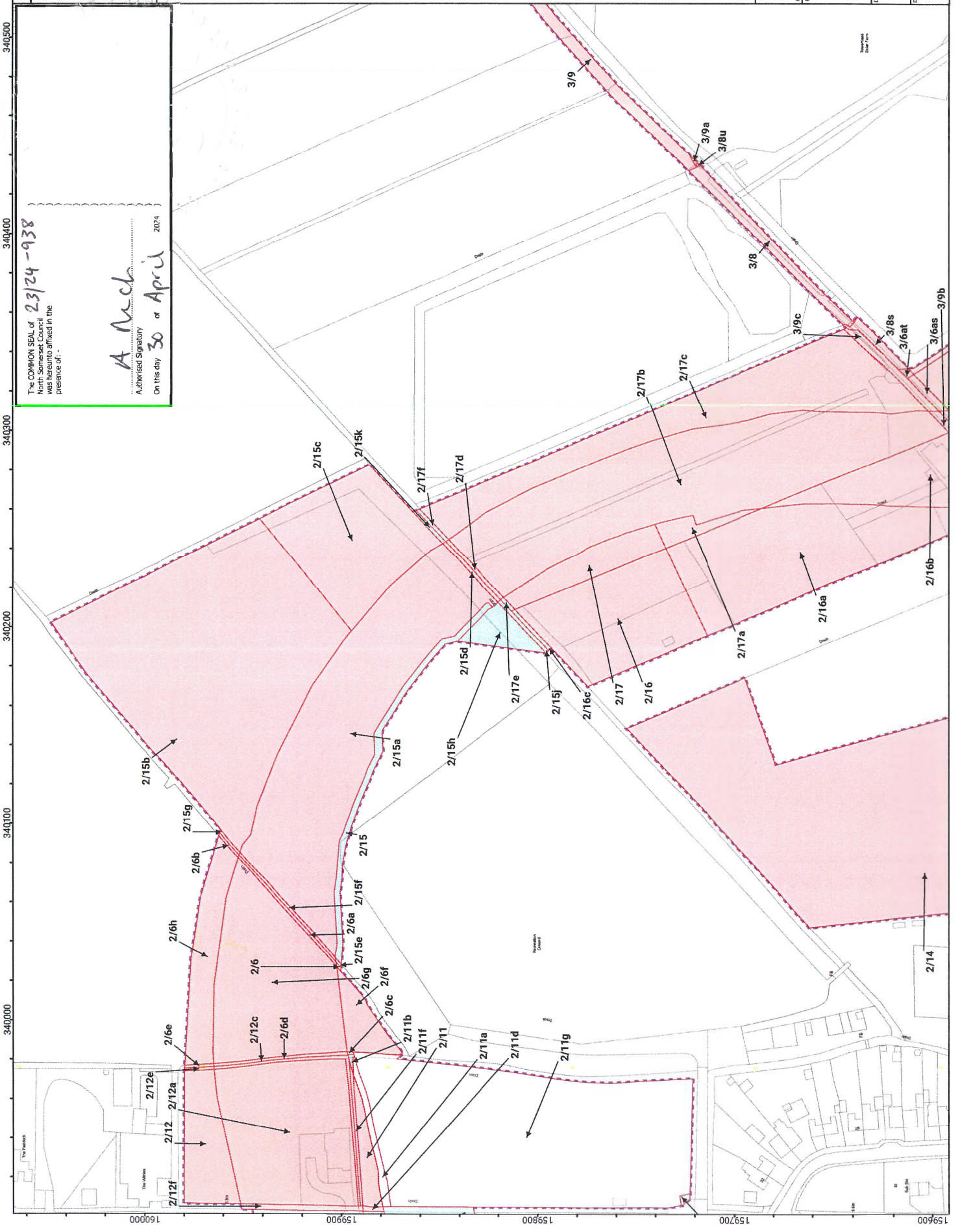

The COMMON SEAL of
North Somerset Council
was hereunto affixed in the
presence of:-

A. N. N. N.
Authorised Signatory

On this day 30 of April 2024

23/24-938

LOCATION PLAN

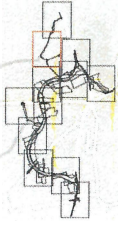

NOTES FOR INFORMATION

- 1. The new highway for which land delineated on this sheet is required, is referred to in the associated Planning Application Reference Number 22/P/2024.
- 2. For construction and improvement of highways in pursuance of the associated Side Roads Order on land delineated on this sheet, see Site Plan 1 of the North Somerset Council (Banwell Classified Road) (Side Roads) Order 2022.

© Crown Copyright and database right 2024
Ordnance Survey, License Number 100022977

LEGEND

- ORDER LAND
- LAND TO BE ACQUIRED
- NEW RIGHTS TO BE ACQUIRED
- ORDER PLOT (EXCLUDED FROM GVD)

N SCALE: 1:2,500 @ A4



PROJECT TITLE

MAP REFERRED TO IN THE NORTH SOMERSET COUNCIL (BANWELL BYPASS AND SOUTHERN LINK) GENERAL VESTING DECLARATION (NO. 1)

DRAWING TITLE

SHEET 8 OF 12

PROJECT NUMBER

GVD_BANWELL_0008_Rev0

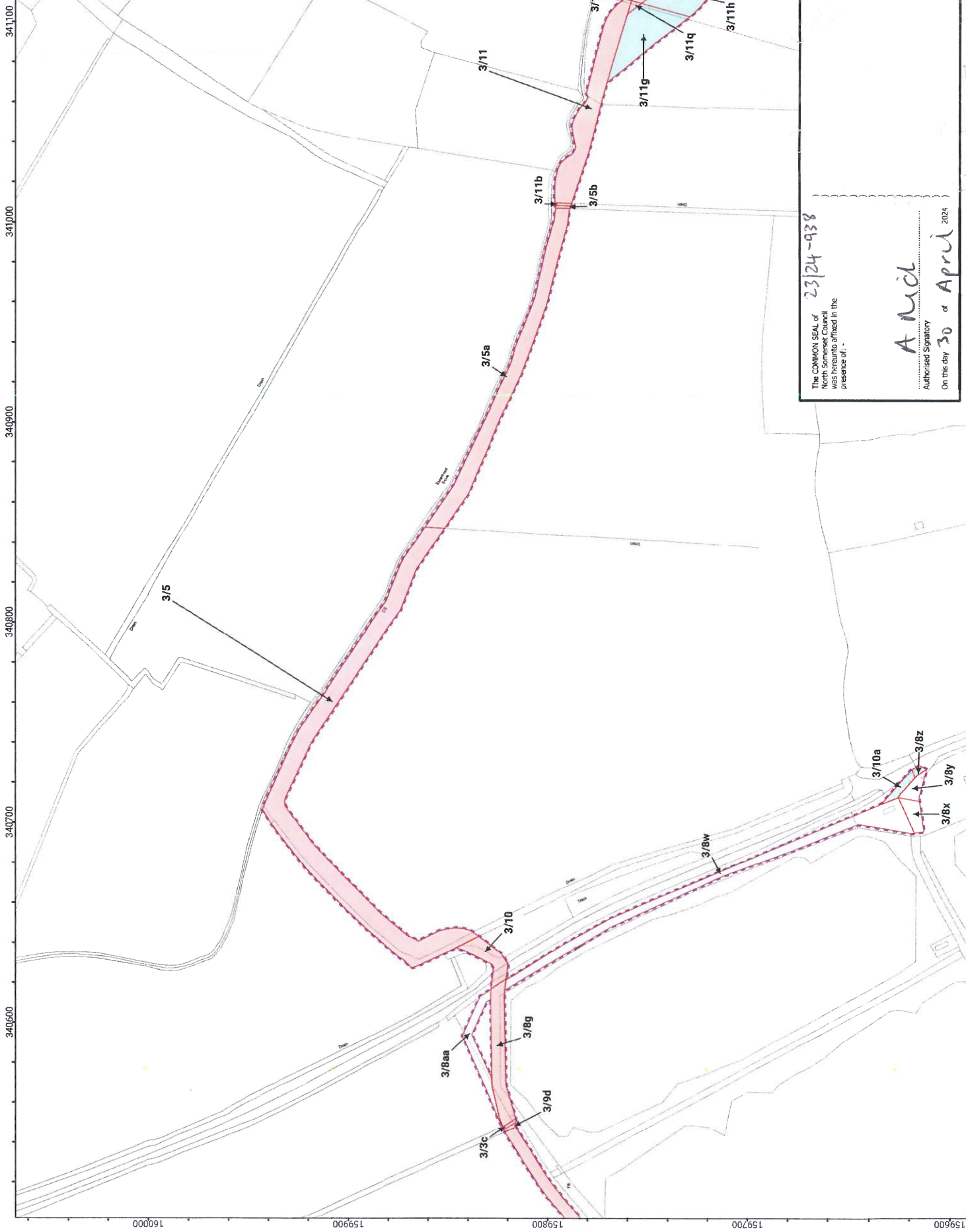

The COMMON SEAL of North Somerset Council was hereunto affixed in the presence of: -

23/24-938

A. Andl

Authorised Signatory

On the day 30 of April 2024

LOCATION PLAN

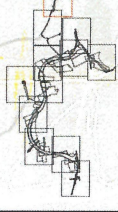

NOTES FOR INFORMATION

- 1. The new highway for which land delineated on this sheet is required, is referred to in the associated Planning Application Reference Number 22/P/23/00000000.
- 2. For construction and improvement of highways in pursuance of the associated Side Roads Order on land delineated on this sheet, see Site Plan 1 of the North Somerset Council (Banwell Bypass and Southern Link) General Vestibule Declaration (No. 1) Classified Road (Sixth Roads) Order 2022.

© Crown copyright and database right 2024
Ordnance Survey, License Number 100023971

LEGEND

- ORDER LAND
- LAND TO BE ACQUIRED
- NEW RIGHTS TO BE ACQUIRED

SCALE: 1:2,500 @ A4
0 12.5 25 50 Metres

PROJECT TITLE

MAP REFERRED TO IN THE NORTH SOMERSET COUNCIL (BANWELL BYPASS AND SOUTHERN LINK) GENERAL VESTIBULE DECLARATION (No. 1)

DRAWING TITLE

SHEET 9 OF 12

DRAWING NUMBER

GVD_BANWELL_0009_RevD

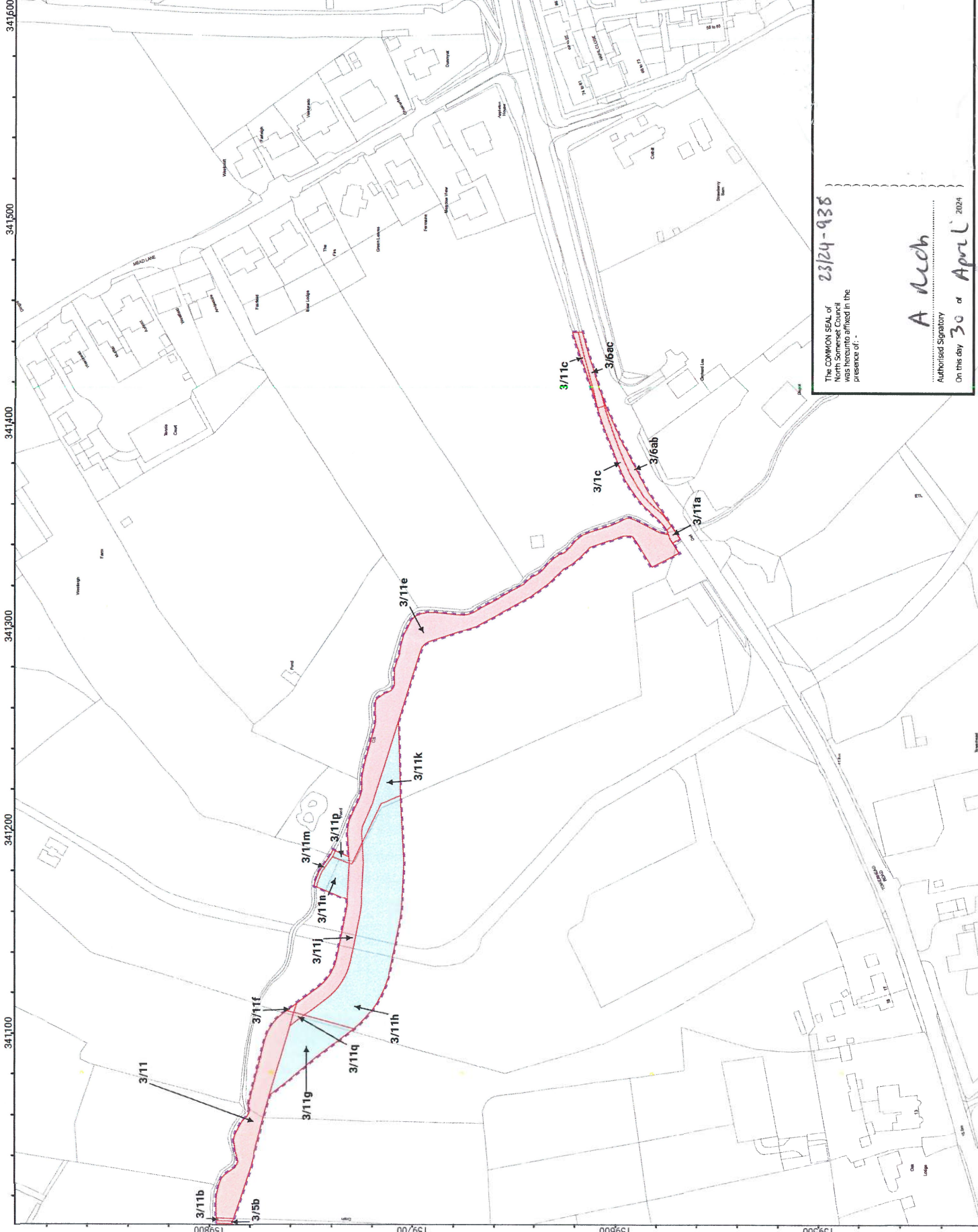

23/24-938

The COMMON SEAL of
North Somerset Council
was hereunto affixed in the
presence of:

A. N. O. B.

Authorised Signatory

On this day 30 of April 2024

LOCATION PLAN



NOTES FOR INFORMATION

1. The new highway for which land delineated on this sheet is required, is referred to in the associated Planning Application Reference Number 22/P/17/08
2. For a complete and improved of highway see the associated associated Side Roads Order on land delineated on this sheet, see Site Plan 1 of the North Somerset Council (Banwell Bypass and Southern Link Classified Road) (Side Roads) Order 2023.

© Crown Copyright and Database rights 2024
Ordnance Survey Licence Number 10002397

LEGEND

- ORDER LAND
- LAND TO BE ACQUIRED
- NEW RIGHTS TO BE ACQUIRED
- ORDER PLOT (EXCLUDED FROM GVD)

N SCALE: 1:2,500 @ A4
0 12.5 25 50 Metres

PROJECT TITLE
MAP REFERRED TO IN THE NORTH SOMERSET COUNCIL (BANWELL BYPASS AND SOUTHERN LINK) GENERAL VESTING DECLARATION (NO. 1)

DRAWING TITLE
SHEET 10 OF 12

DRAWING NUMBER
GVD_BANWELL_0010_RevD

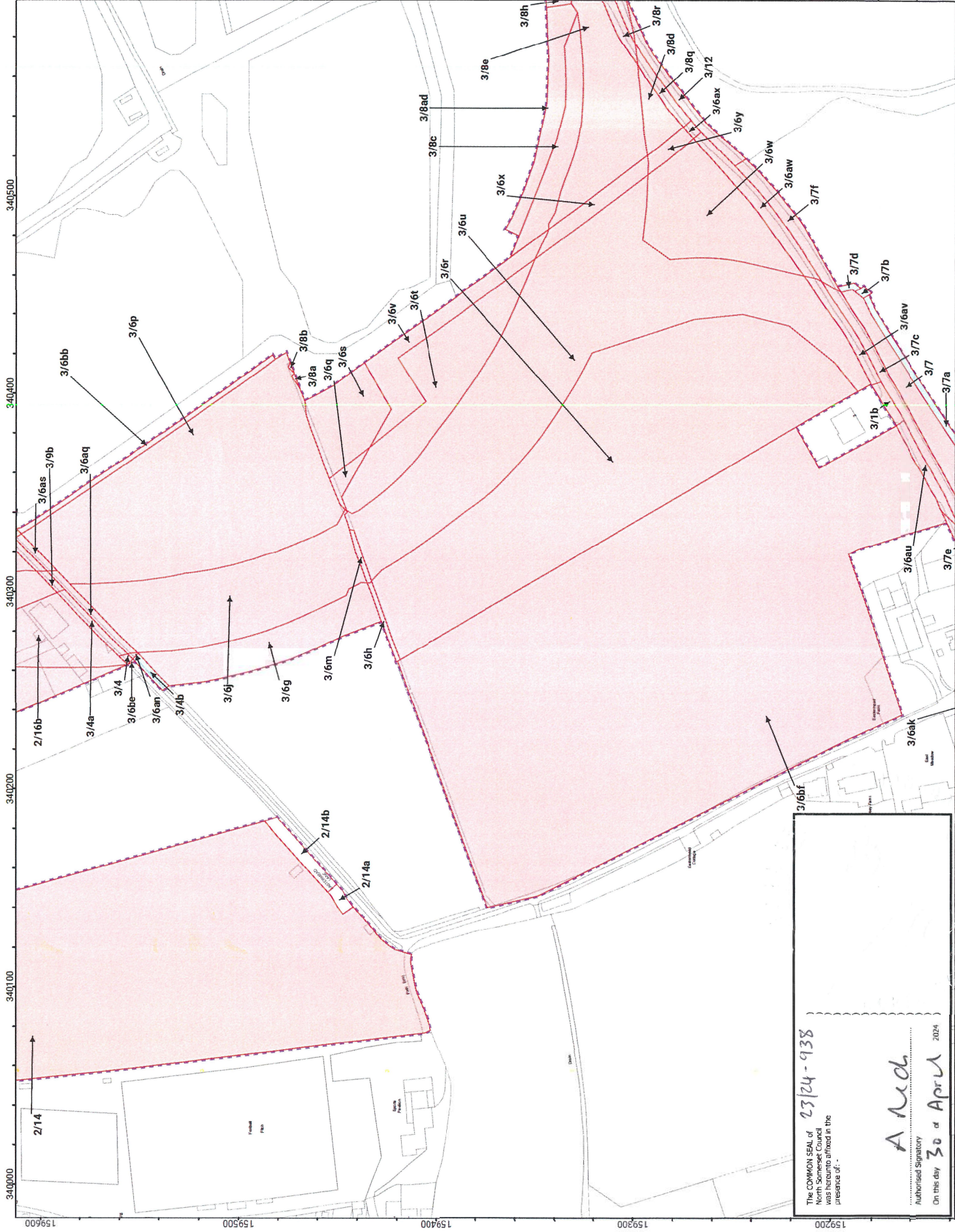

The COMMON SEAL of
North Somerset Council
is hereby affixed in the
presence of:-

A. Nd.
Authorised Signatory

On this day *30* of *April* 2024

23/24-938

LOCATION PLAN

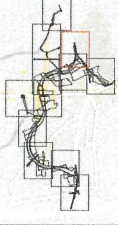

NOTES FOR INFORMATION

- 1. The new highway for which land delineated on this sheet is required, is referred to in the associated Planning Application Reference Number 22/P/2762.
- 2. For construction and improvement of highways in pursuance of the associated Side Roads Order on land delineated on this sheet, see Site Plan 1 of the North Somerset Council (Banwell Bypass and Southern Link) General Vesting Declaration (No. 1), Classified Road (S&K Roads) Order 2022.

© Crown copyright and database right 2024
Ordnance Survey. License Number: 10002397

LEGEND

- ORDER LAND
- LAND TO BE ACQUIRED
- NEW RIGHTS TO BE ACQUIRED

SCALE: 1:2,500 @ A4
0 12.5 25 50 Metres

PROJECT TITLE

MAP REFERRED TO IN THE NORTH SOMERSET COUNCIL (BANWELL BYPASS AND SOUTHERN LINK) GENERAL VESTING DECLARATION (No. 1)

DRAWING TITLE

SHEET 11 OF 12

DRAWING NUMBER

GVD_BANWELL_0011_Rev0

340400 340500 340600 340700 340800 340900

159500 159400 159300 159200 159100

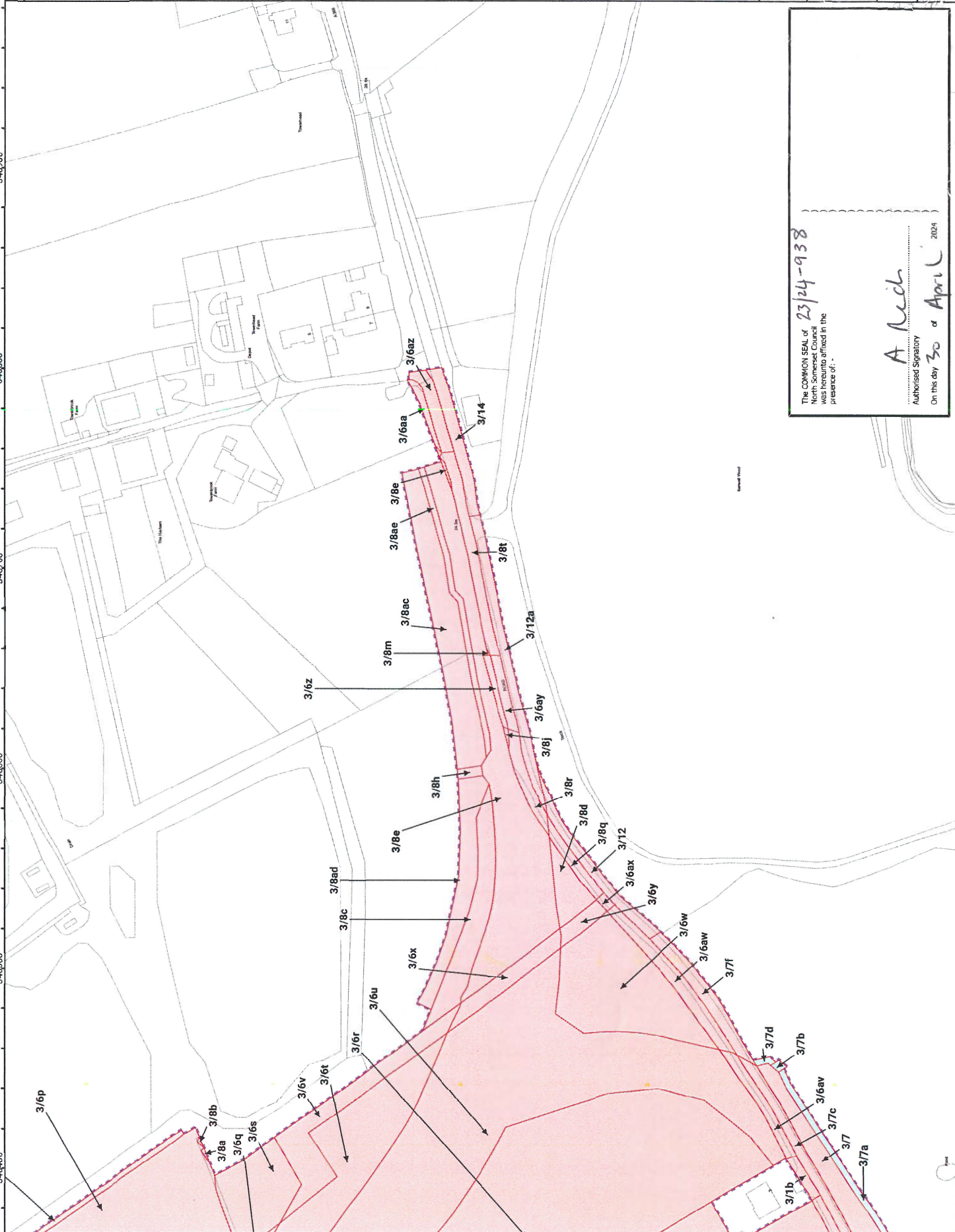

The COMMON SEAL of
North Somerset Council
was hereunto affixed in the
presence of: -

A Nech
Authorised Signatory

On the day *30* of *April* 2024

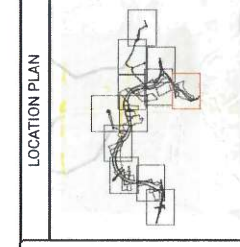

NOTES FOR INFORMATION

- The new highway for which land delineated on this sheet is required, is referred to in the associated Planning Application Reference Number 22/P/1763
- Proposed construction and improvement of highways in pursuance of the associated Side Roads Order on land delineated on this sheet, see Site Plan 1 of the North Somerset Council (Banwell Bypass) Order for the North Somerset Council (Banwell Classified Road) (Side Roads) Order, 2022.

© Crown copyright and database rights 2024
 Ordnance Survey Licence Number: 100023397



N SCALE: 1:2,500 @ A4

PROJECT TITLE
 MAP REFERRED TO IN THE NORTH SOMERSET COUNCIL (BANWELL BYPASS AND SOUTHERN LINK) GENERAL VESTING DECLARATION (NO. 1)

DRAWING TITLE
 SHEET 12 OF 12

DRAWING NUMBER
 GVD_BANWELL_0012_RevD

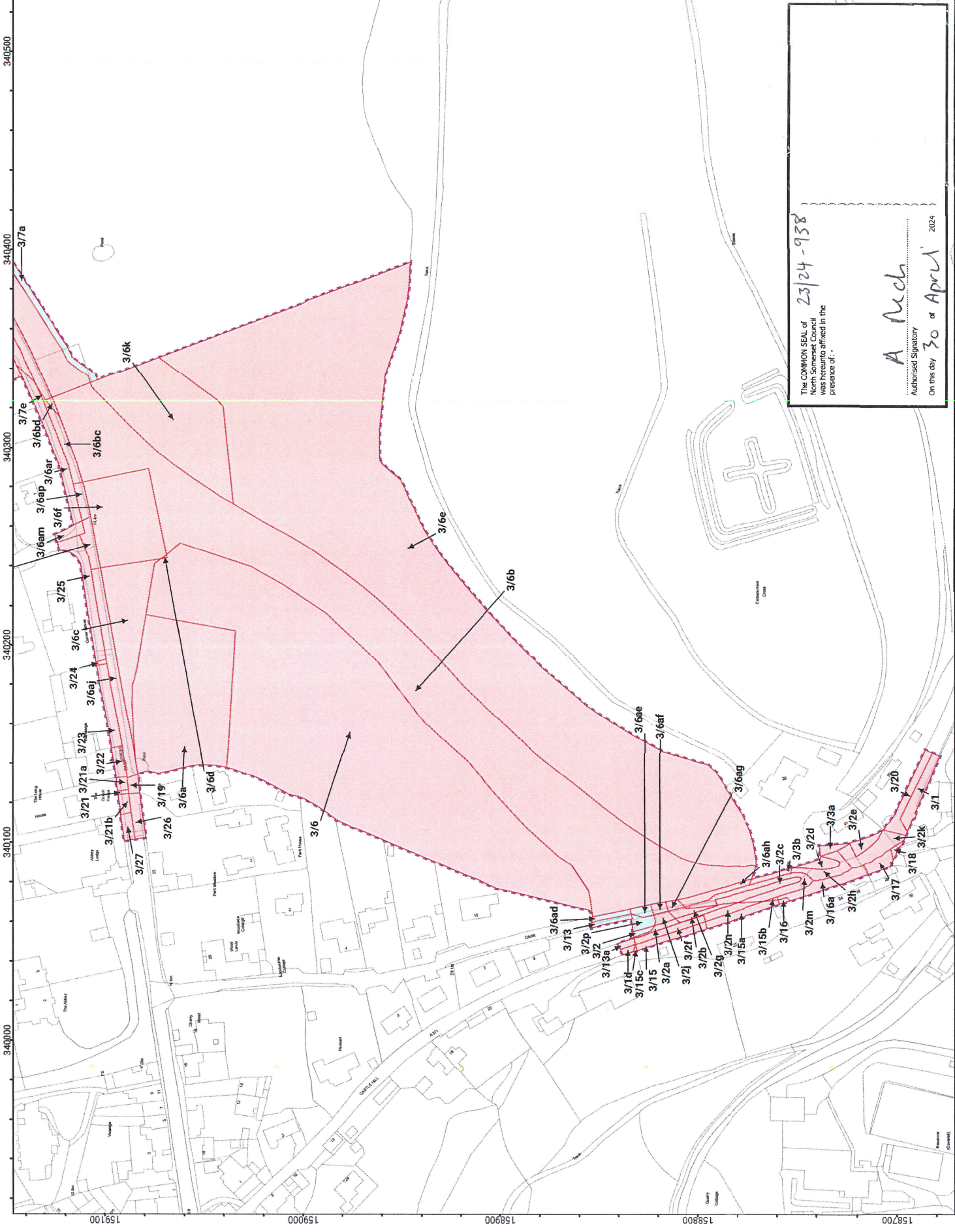

The COMMON SEAL of
 North Somerset Council
 was hereunto affixed in the
 presence of: -

A. N. Mch
 Authorised Signatory

On the day *30* of *April* 2024